



Robotic Solution

Modular 7th Axis Linear Actuator

Exclusively for Hanwha Robots

BENEFITS

- Transition plates and hardware available for direct mounting between electric linear actuator and robot.
- Torque limiting features on servo-driven linear actuator can provide faults in case of collisions.*
- With a maximum stroke of 5,500 mm, the 7th axis linear actuator can multiply working area of the robot tenfold.

| HANWHA ROBOTS | HCR-3 | HCR-5 | HCR-12 |
|------------------------|----------|----------|----------|
| MAXIMUM PAYLOAD | 3 kg | 5 kg | 12 kg |
| REACH | 630 mm | 915 mm | 1300 mm |
| WEIGHT | 13 kg | 21 kg | 53 kg |
| RECOMMENDED 7th AXIS** | ESUS55 | ESUD56 | ESUD58 |
| TRANSITION PLATE | ML318421 | ML318422 | ML318423 |
| PLATE WEIGHT | 0.9 kg | 3.0 kg | 4.6 kg |

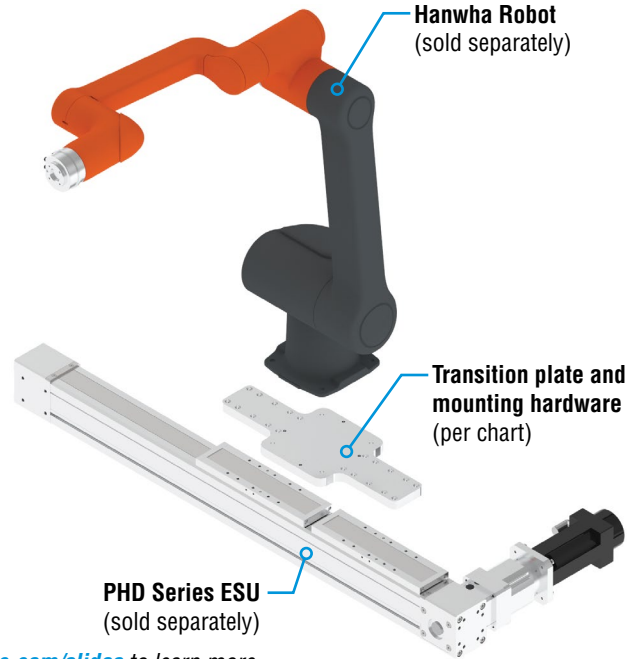

Visit phdinc.com/slides to learn more.

The robust design of the Series ESU Electric Belt-Driven Linear Actuator provides a superior guide system to support the robot in various orientations.

Vertical Mounting

(Vertical Mounting is currently only available for HCR-3 and HCR-5. The HCR-12 will require a different bracket. Consult PHD for more information.)

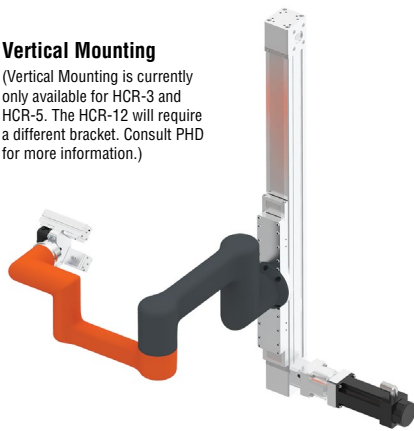

Overhead Mounting



Wall Mounting

(Wall Mounting is currently only available for HCR-3 and HCR-5. The HCR-12 will require a different bracket. Consult PHD for more information.)



*Series ESU Electric Linear Actuators are not collaborative rated from PHD. Customer assumes the responsibility of risk assessment.

**Recommended linear actuator selected for maximum payload and reach of robot. Contact PHD Applications Engineering for other combinations.

© Copyright 2020, by PHD, Inc. All Rights Reserved. Printed in the U.S.A.

CPHABASESLIDE



PHD is a member of the
MAC Distributor Network

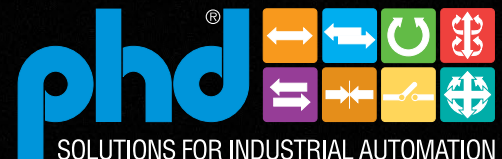

www.phdinc.com

DIMENSIONS: TRANSITION PLATES

ML318421

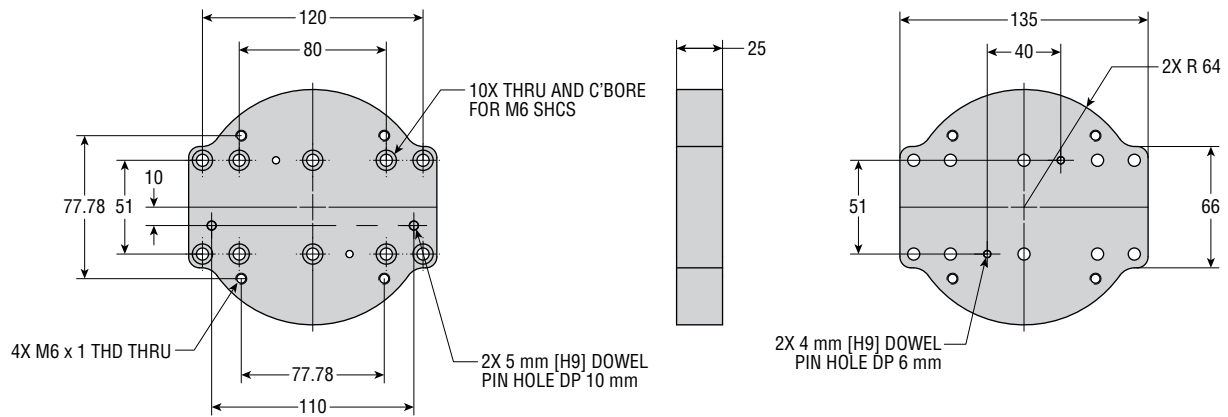

ML318422

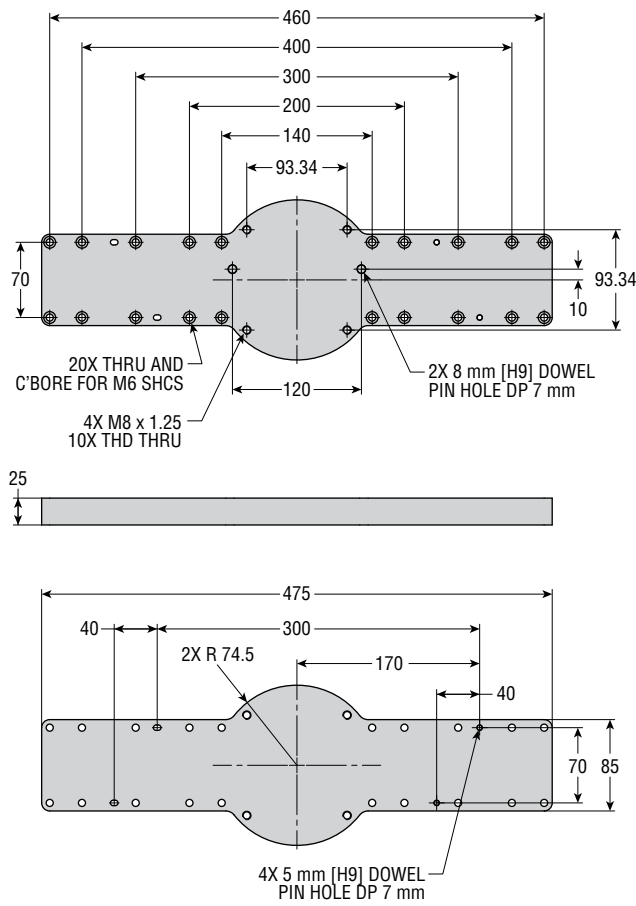

ML318423

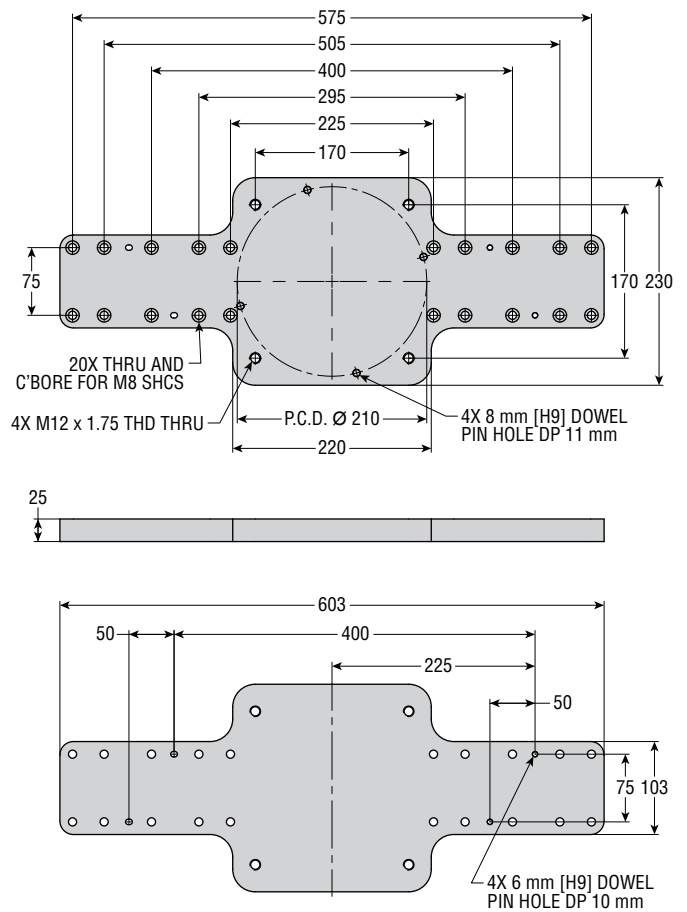

All dimensions are reference only unless specifically tolerated.