



Stamping Solution

Hydraulic Die Retention Cylinder

ML#312447 & ML#312726

BENEFITS

- Drop-in replacement
- 50 to 4,000 psi operating pressure range- hydraulic
- Field repairable, increases value and provides longer life
- PHD offers rebuild program providing same warranty as new unit
- Spring extend for ease of setup
- Safe disassembly (springs decompress before bolts disengage - ML312447 only*)
- Chrome-plated rod increases life
- Other port threads available
- Improved holding force



ML#312447

*ML#312447

SPECIFICATIONS	IMPERIAL	METRIC
STROKE	.315"	8 mm
BORE	3.125	79.4 mm
MIN OPERATING PRESSURE	50 psi	3.45 bar
MAX OPERATING PRESSURE	4000 psi	276 bar
FORCE AT 4,000 PSI (276 bar)	29,515 lb	131 KN



ML#312726

ML#312726

SPECIFICATIONS	IMPERIAL	METRIC
STROKE	.320	8.13 mm
BORE	2.5	63.5 mm
MIN OPERATING PRESSURE	50 psi	3.45 bar
MAX OPERATING PRESSURE	6000 psi	414 bar
FORCE AT 6,000 PSI (414 bar)	29,452 lb	131 KN

CP312447C



PHD is a member of the
MAC Distributor Network



SOLUTIONS FOR INDUSTRIAL AUTOMATION

PHD, Inc. • P.O. Box 9070 • Fort Wayne, IN 46899 • (260) 747-6151 • FAX (260) 747-6754
www.phdinc.com • phdinfo@phdinc.com

DIMENSIONS: ML#312447 & ML#312726

ML#312447

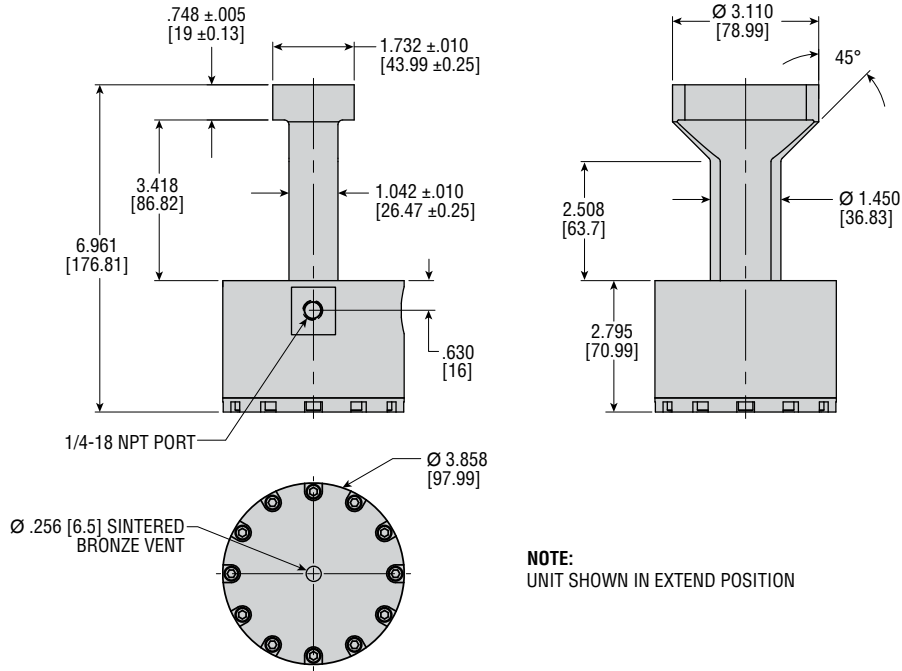

NOTE:
UNIT SHOWN IN EXTEND POSITION

ML#312726

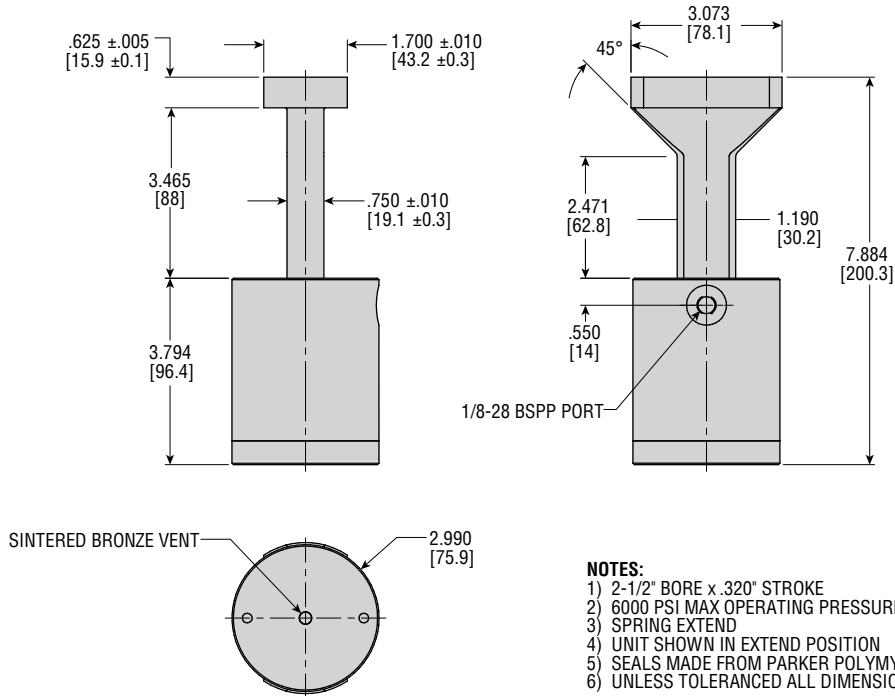

NOTES:
 1) 2-1/2" BORE x .320" STROKE
 2) 6000 PSI MAX OPERATING PRESSURE
 3) SPRING EXTEND
 4) UNIT SHOWN IN EXTEND POSITION
 5) SEALS MADE FROM PARKER POLYMYTE
 6) UNLESS TOLERANCED ALL DIMENSIONS ARE FOR REFERENCE