

# GRM Size 0

## PNEUMATIC WORKHOLDING CLAMPS



*Designed for high force in an extremely compact package*

- Compact, lightweight
- Generates up to 135 lb [600 N] total clamp force
- Locks in closed position



GRM0 Flange  
Jaw Style 'F'

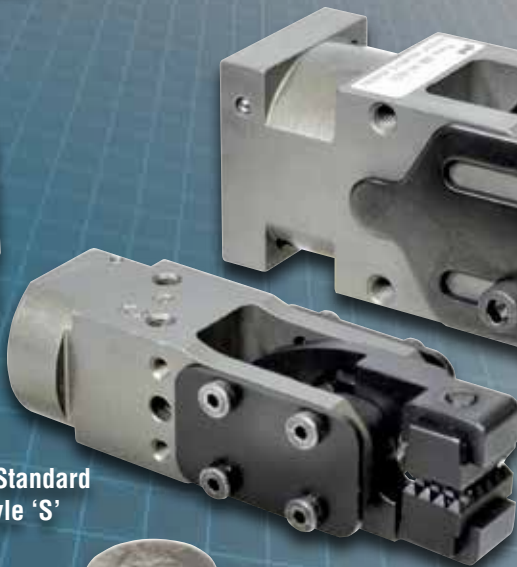

GRM0 Standard  
Jaw Style 'S'



Industry's most popular sheet  
metal handling clamp:  
**PHD Series GRM Size 2**



**ISO 9001  
REGISTERED**

Quality Management  
System Certified

GRM0



PHD is a member of the  
MAC Distributor Network

**phd**   
SOLUTIONS FOR INDUSTRIAL AUTOMATION

[www.phdinc.com](http://www.phdinc.com)

# GRM Size 0



## PNEUMATIC WORKHOLDING CLAMPS

### Major Benefits

- Compact envelope size, lightweight, and strong. Under 0.53 lb [0.24 kg] clamp generates up to 135 lb [600 N] of total clamp force.
- Simple design, long life, and fast field maintenance.
- The clamp jaws lock in the closed position, ensuring part retention if air pressure is lost due to line rupture or power loss.
- Ideal for applications where size and weight are a concern.
- Perfect for robotic crossbar transfer press applications.
- A superior alternative to vacuum cups or magnetic-type grippers due to its ruggedness and part retention in the event of air pressure loss.
- This design includes the -B11 Side Mount Body option as standard to accept standard side mounting brackets for additional mounting flexibility.

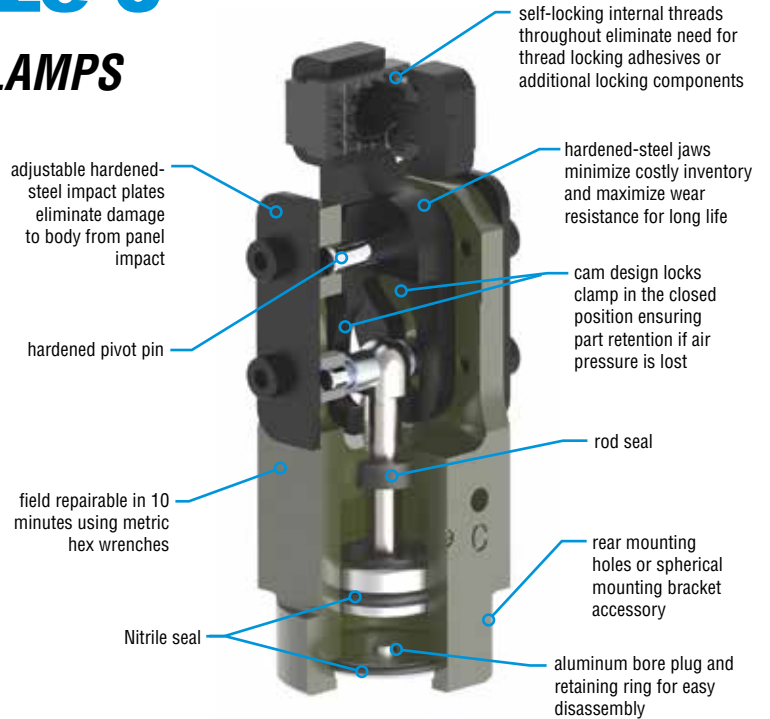

## ORDERING DATA: GRM0

Blue shaded options now available

Gray shaded options will be available in Q4 2020

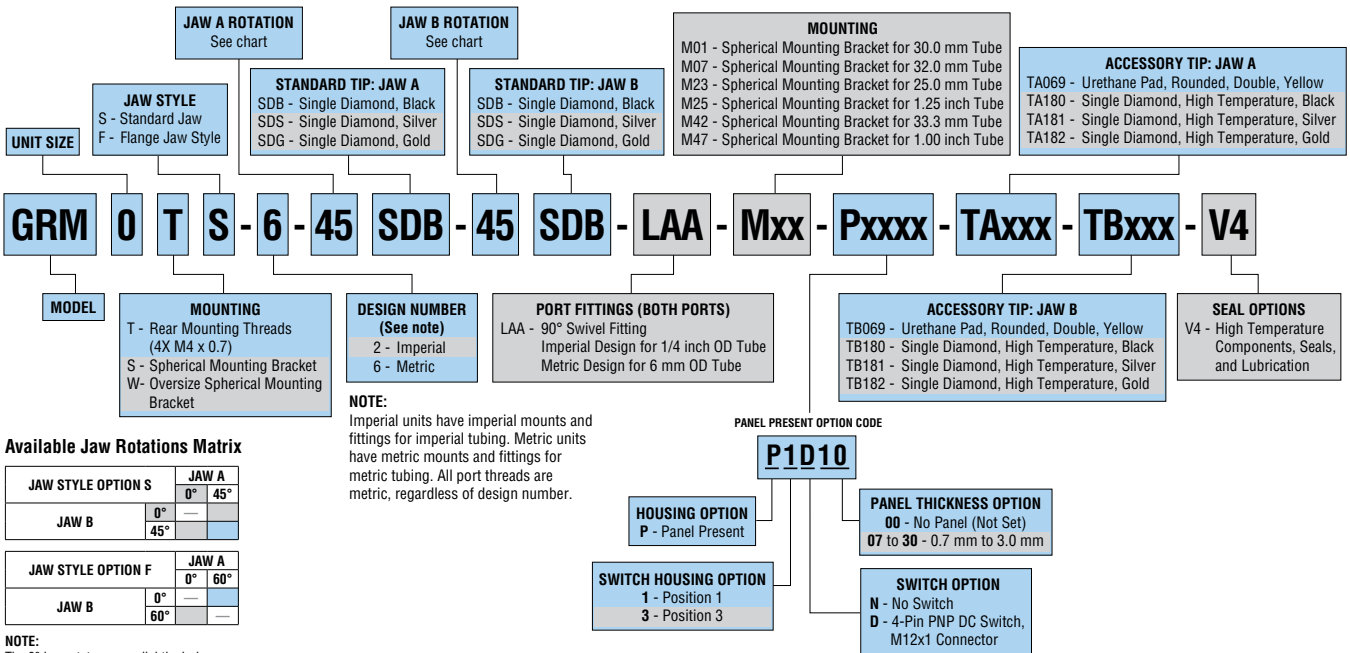

### Available Jaw Rotations Matrix

JAW STYLE OPTION S		JAW A	
JAW B	0°	0°	45°
JAW B	45°		

JAW STYLE OPTION F		JAW A	
JAW B	0°	0°	60°
JAW B	60°		

### NOTE:

The 0° jaw rotates open slightly during the clamp cycle. The 0° jaw returns to 0° position as the opposing jaw reaches the fully open or fully closed positions.

### GRM0 MODELS CURRENTLY AVAILABLE

JAW STYLE 'S'	
GRM0 T S - 6 - 45 SDB - 45 SDB	
GRM0 T S - 6 - 45 SDB - 45 SDB - P1D00	
GRM0 T S - 6 - 45 SDB - 45 SDB - P1N00	
GRM0 T S - 6 - 45 - 45 - TA069 - TB069	
GRM0 T S - 6 - 45 - 45 - P1D00 - TA069 - TB069	
GRM0 T S - 6 - 45 - 45 - P1N00 - TA069 - TB069	

JAW STYLE 'F'	
GRM0 T F - 6 - 60 SDB - 00 SDB	
GRM0 T F - 6 - 60 SDB - 00 SDB - P1D00	
GRM0 T F - 6 - 60 SDB - 00 SDB - P1N00	
GRM0 T F - 6 - 60 - 00 - TA069 - TB069	
GRM0 T F - 6 - 60 - 00 - P1D00 - TA069 - TB069	
GRM0 T F - 6 - 60 - 00 - P1N00 - TA069 - TB069	

# ENGINEERING DATA: GRM0

MODEL	UNIT WEIGHT		TOTAL GRIP FORCE at 87 psi [6 bar]		CYCLE TIME at 87 psi [6 bar]	PRESSURE LIMITS				TEMPERATURE LIMITS			
						MIN.		MAX.		MIN.		MAX.	
	lb	kg	lb	N	second	psi	bar	psi	bar	°F	°C	°F	°C
GRM0	0.53	0.24	135	600	0.15	30	2	100	7	-20	-30	180	82

## DIMENSIONS: GRM0

### STANDARD JAW STYLE 'S'

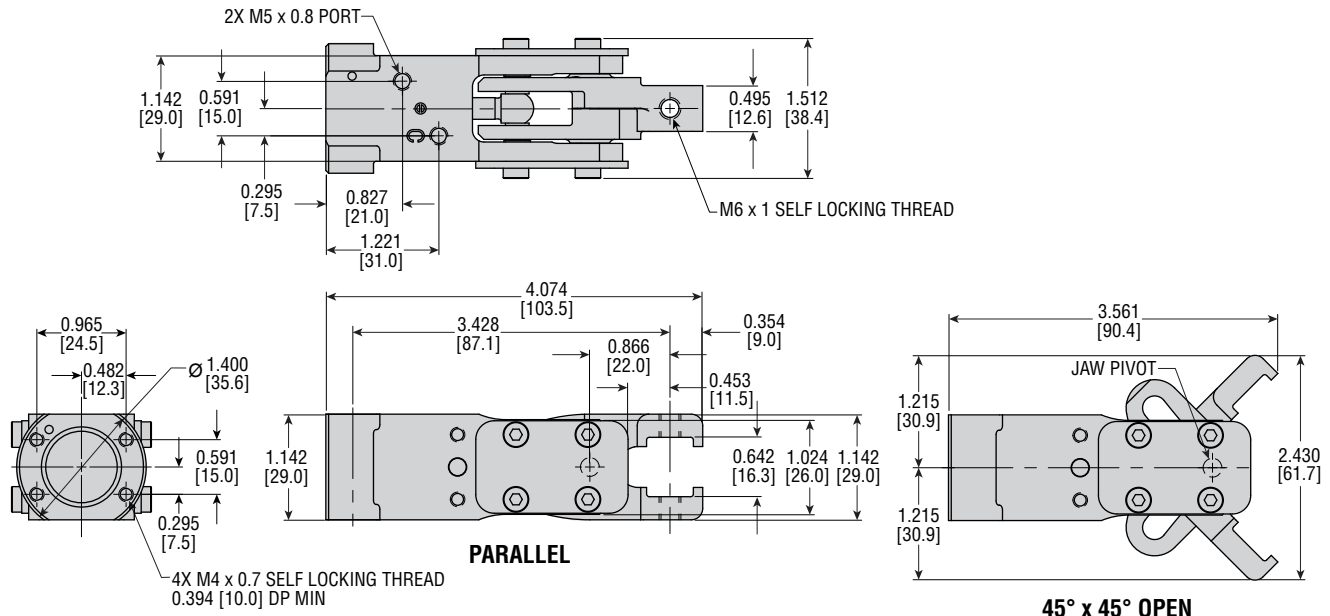

NOTE:  
1) ALL METRIC DIMENSIONS [ ] ARE GIVEN IN MILLIMETERS

### FLANGE JAW STYLE 'F'

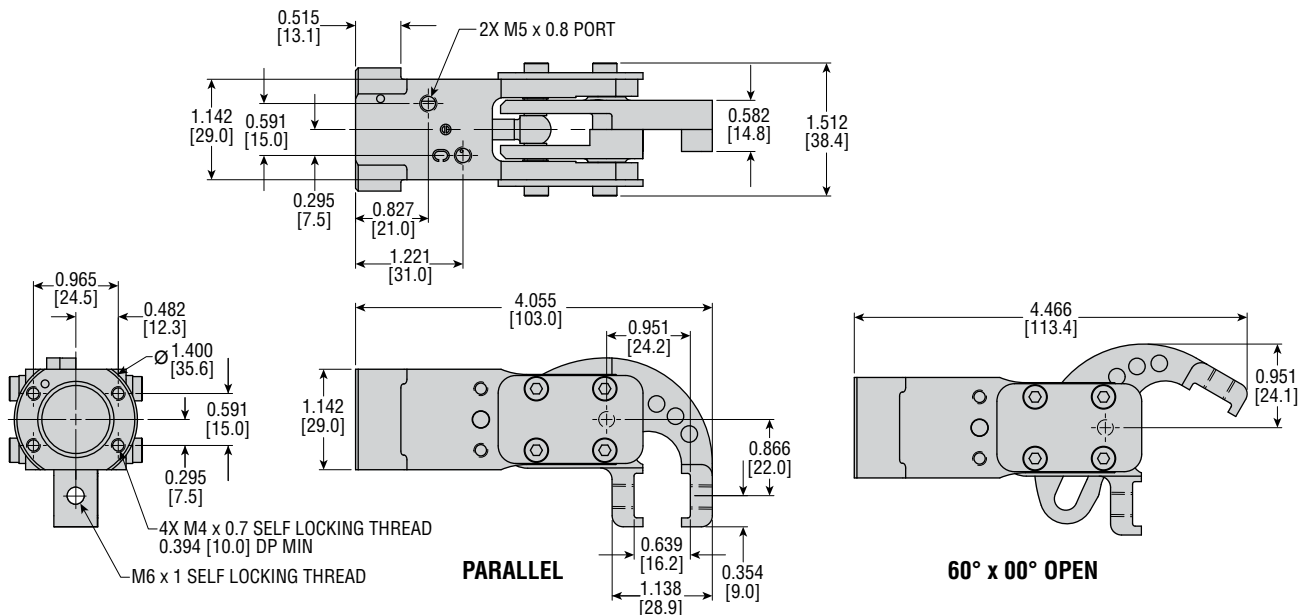

NOTE:  
1) ALL METRIC DIMENSIONS [ ] ARE GIVEN IN MILLIMETERS

# TIP DIMENSIONS: GRM0

## STANDARD TIP (SBD)

Single Diamond Point - Black

Tip Weight: 0.033 lb [15 g]

Material Thickness Range: 0 to 0.8 mm

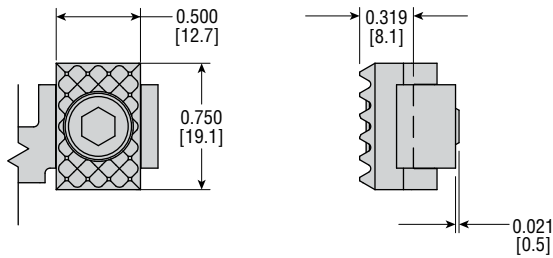

## URETHANE TIP (Tx069)

Double Rounded Hard Urethane - Yellow

Tip Weight: 0.031 lb [14 g]

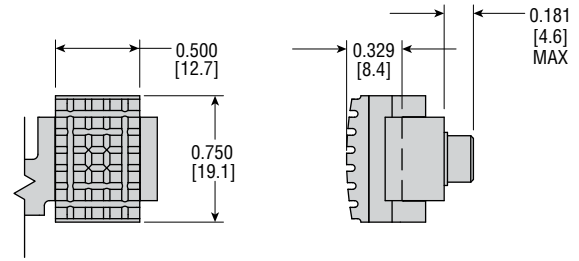

**NOTE:**

1) ALL METRIC DIMENSIONS [ ] ARE GIVEN IN MILLIMETERS

# SWITCH OPTION DIMENSIONS: GRM0

## P1x00 PANEL PRESENT DETECTION

PANEL PRESENT OPTION CODE

**P1D10**

**HOUSING OPTION**  
P - Panel Present

**PANEL THICKNESS OPTION**  
00 - No Panel (Not Set)  
07 to 30 - 0.7 mm to 3.0 mm

**SWITCH HOUSING OPTION**  
1 - Position 1  
3 - Position 3

**SWITCH OPTION**  
N - No Switch  
D - 4-Pin PNP DC Switch,  
M12x1 Connector

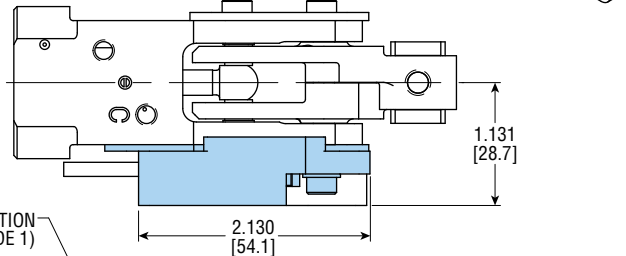
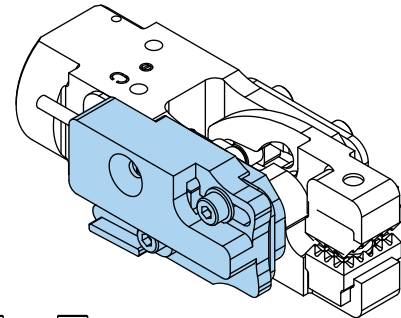

SWITCH CABLE EXIT LOCATION  
(SWITCH ON SIDE 1)

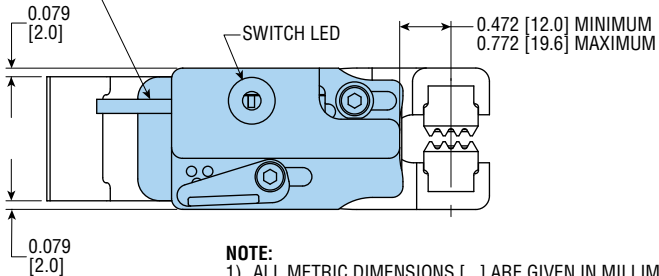
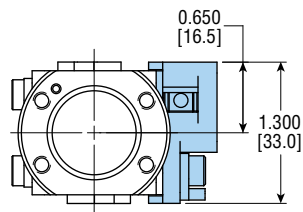

**NOTE:**

1) ALL METRIC DIMENSIONS [ ] ARE GIVEN IN MILLIMETERS

# ACCESSORIES: GRM0

## 90° SWIVEL ELBOW, METAL PORT FITTINGS

PART NO.	DESCRIPTION
62178-064	One 10-32 Male Fitting with o-ring for 1/4" tubing
62195-073	One M5 Male Fitting with o-ring for 6 mm tubing

All dimensions are reference only unless specifically tolerated.